

DJI GO 4 App

Turning off downward vision sensors (IOS)

To turn off the sensors below the aircraft we need to navigate to the DJI Go 4 app.

Once the app is open, as shown on the right side, we navigate to “Enter Device”.

It's important to keep in mind that the aircraft needs to be turned on to enter these settings. Without the aircraft turned on the changes made in the app will not be saved on the aircraft.



Once entered the device we see the home screen where we have all the information for flying. In the top right corner there are three little dots. To enter the menu we need to navigate to those three dots.

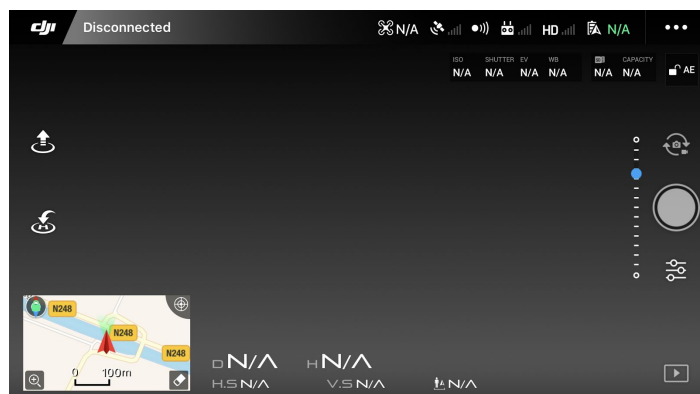

In this menu we go straight to the second menu from the top down. We now are on the tab “Visual Navigation Settings.”

In this menu we scroll down to the bottom where we see the option “Advanced settings.”

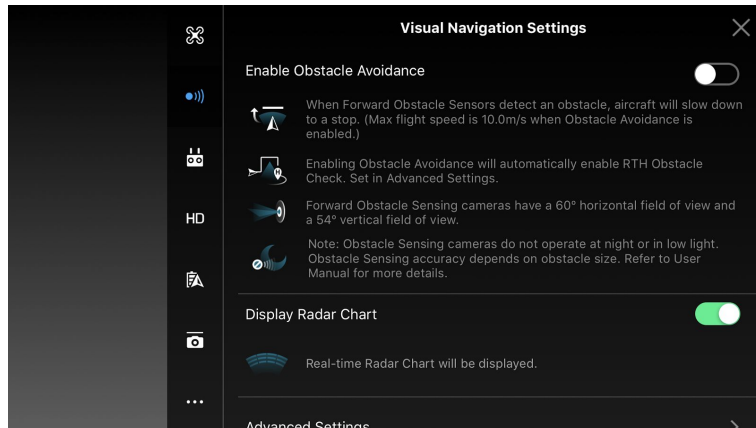

On this menu we have the option “Enable Vision Positioning” the description reads

“Downward Vision Positioning provides accurate, stable hovering without GPS, and supports landing Protection and other systems.”

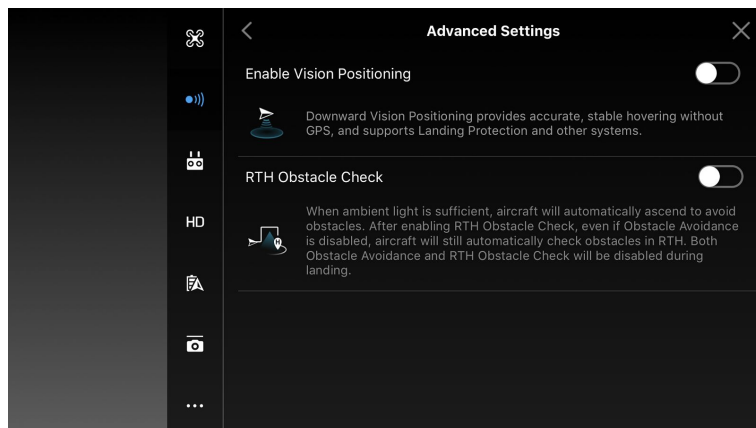

It's important to know that we turn off this setting for the “Landing Protection” part. This setting makes it so that the aircraft won't ascending while we have mounted something for the vision sensors.

DRONExpert Netherlands always suggest to test the aircraft setting changed before attaching mounts to the aircraft. In theory the aircraft can hover around 2 inch above ground without setting in the landing mode.